

50 mm 100 150

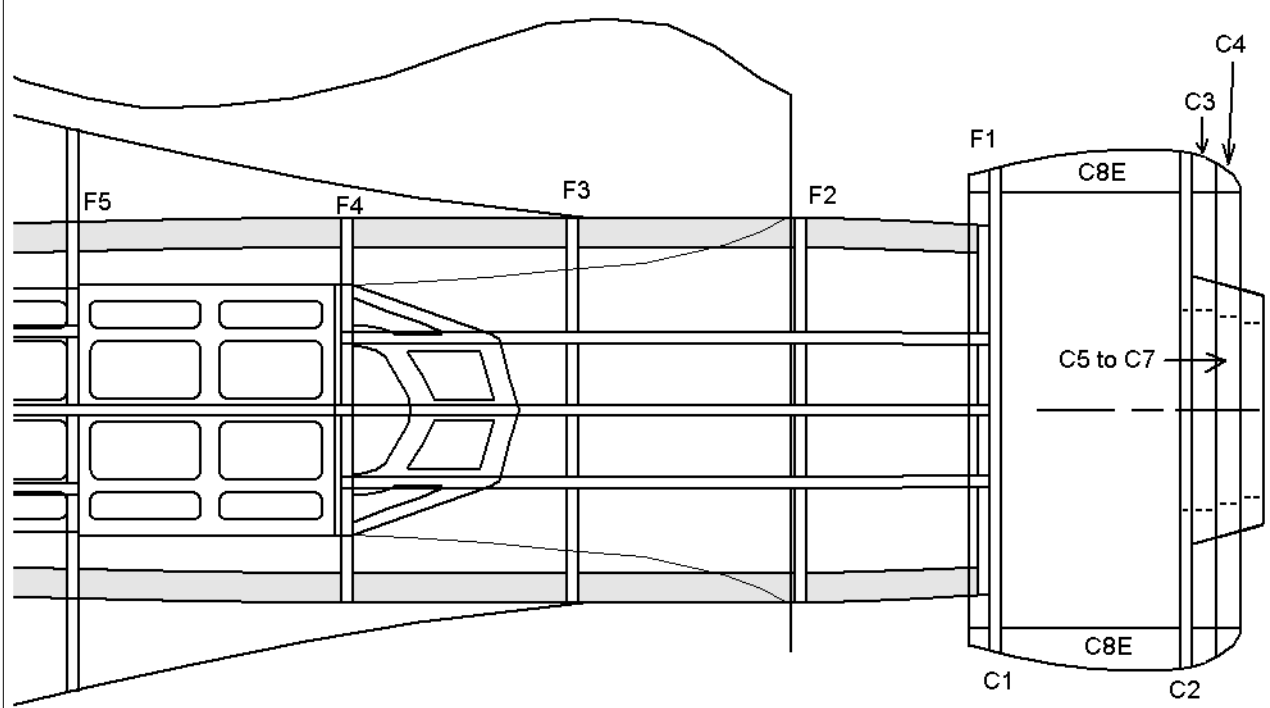

For rubber version
use 7 or 8" prop

16 needed

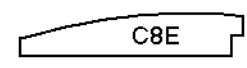

Electric version

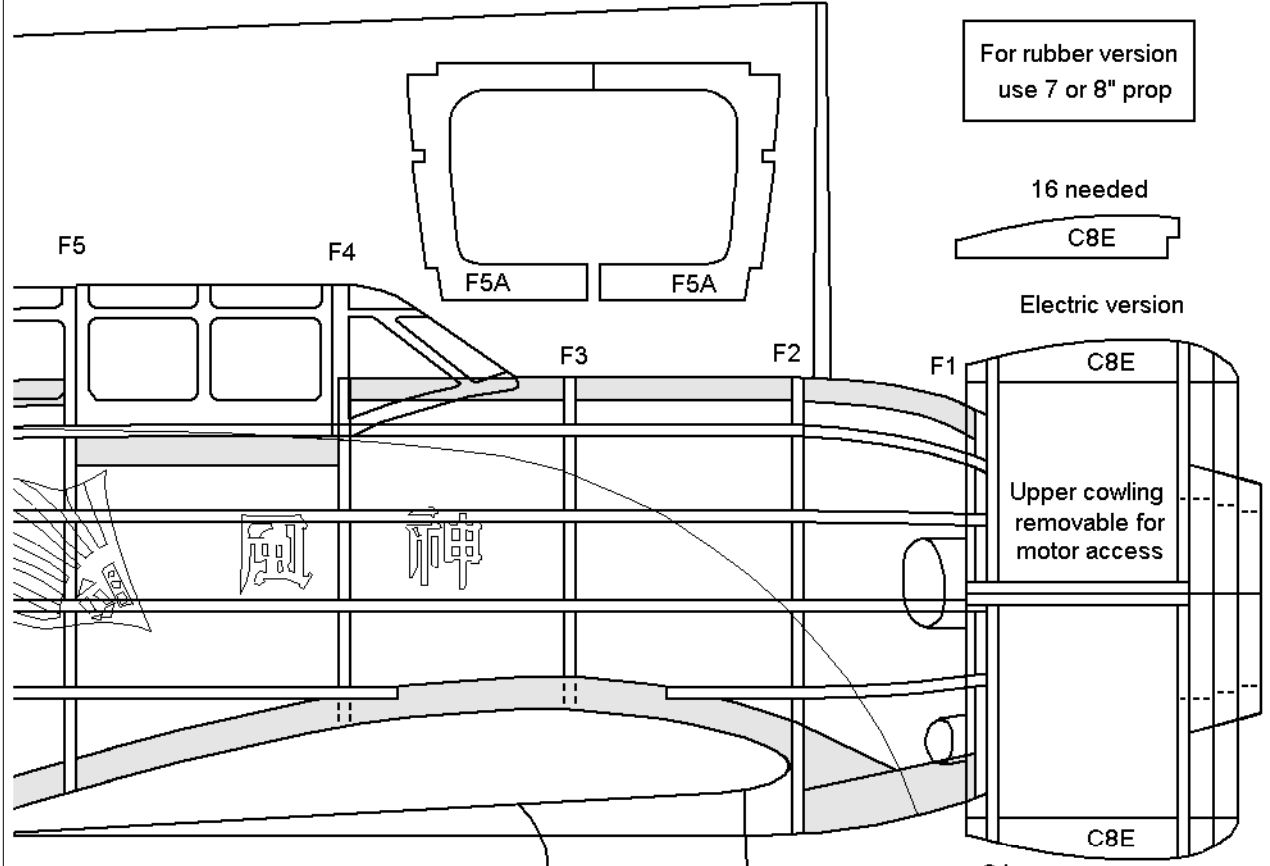

Upper cowling
removable for
motor access

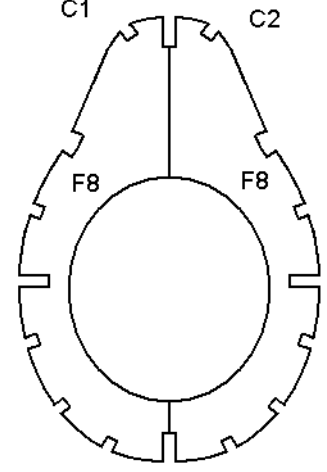
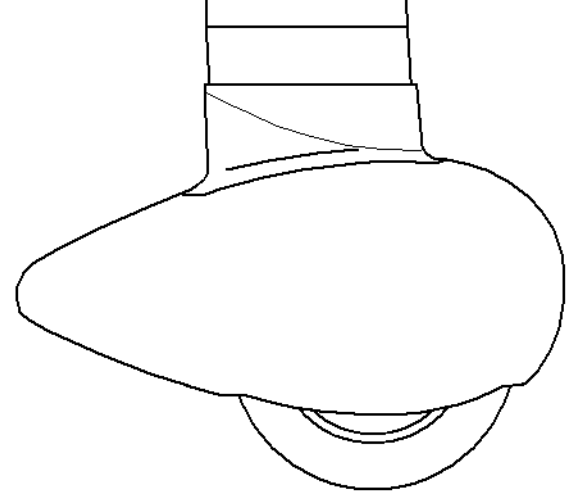
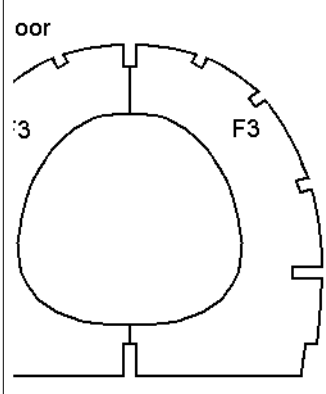

0 50

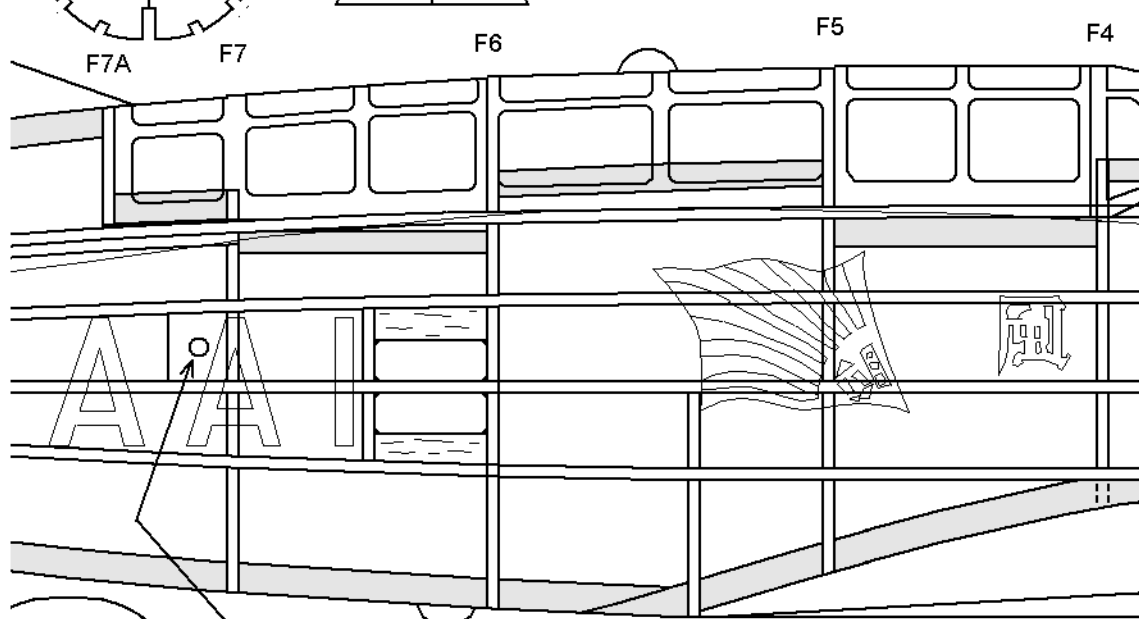
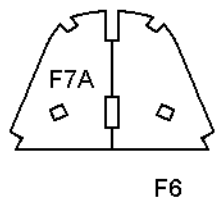
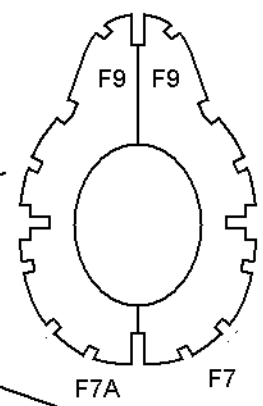
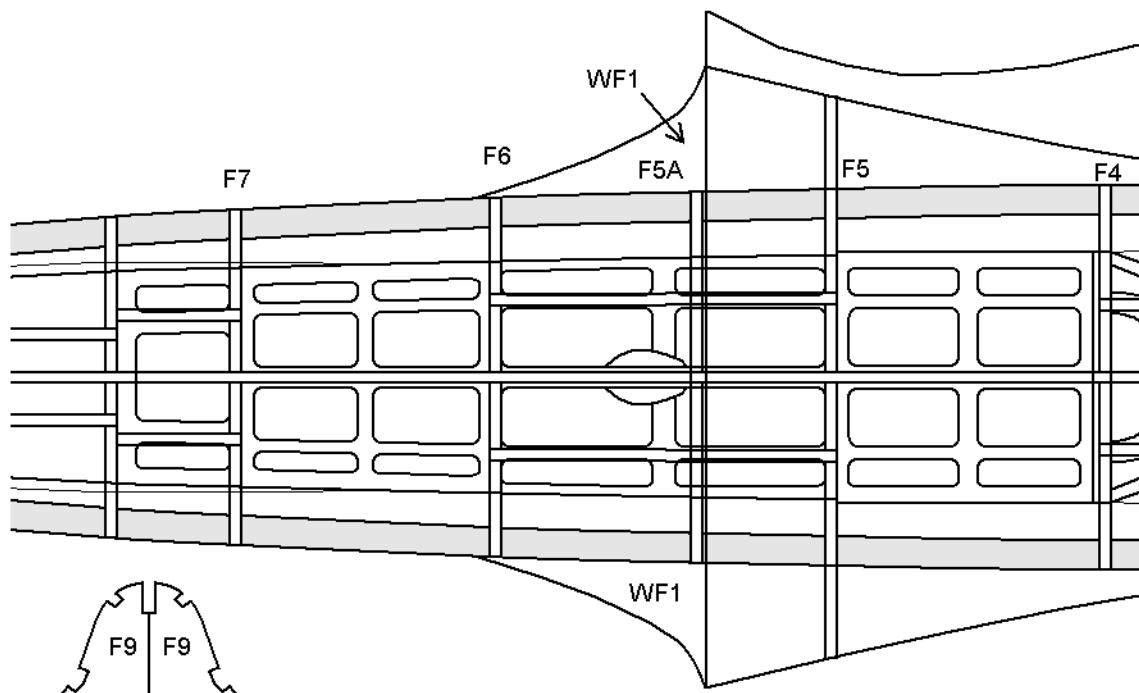

Suggested rubber peg position

Level of cockpit floor

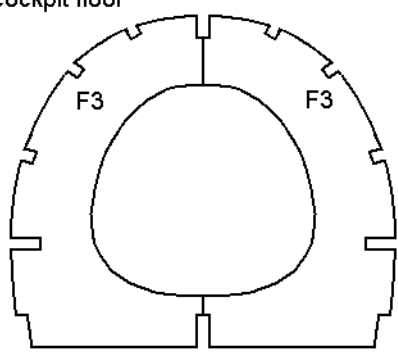
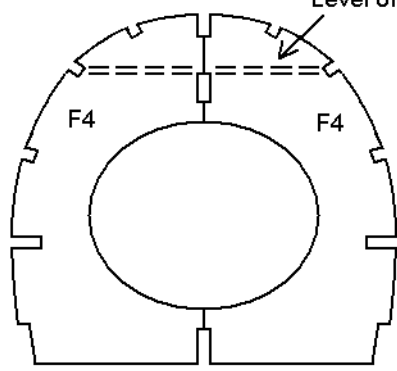
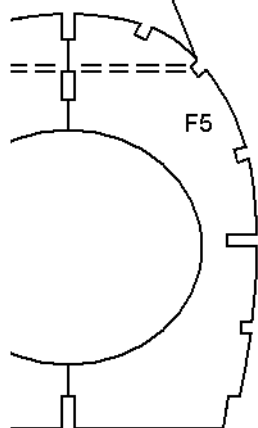

Mitsubishi Ki 15 Karigane I
1/20 scale free flight scale model
for electric or rubber power
 Designed and drawn by Mike Stuart
 Page 1 of 3

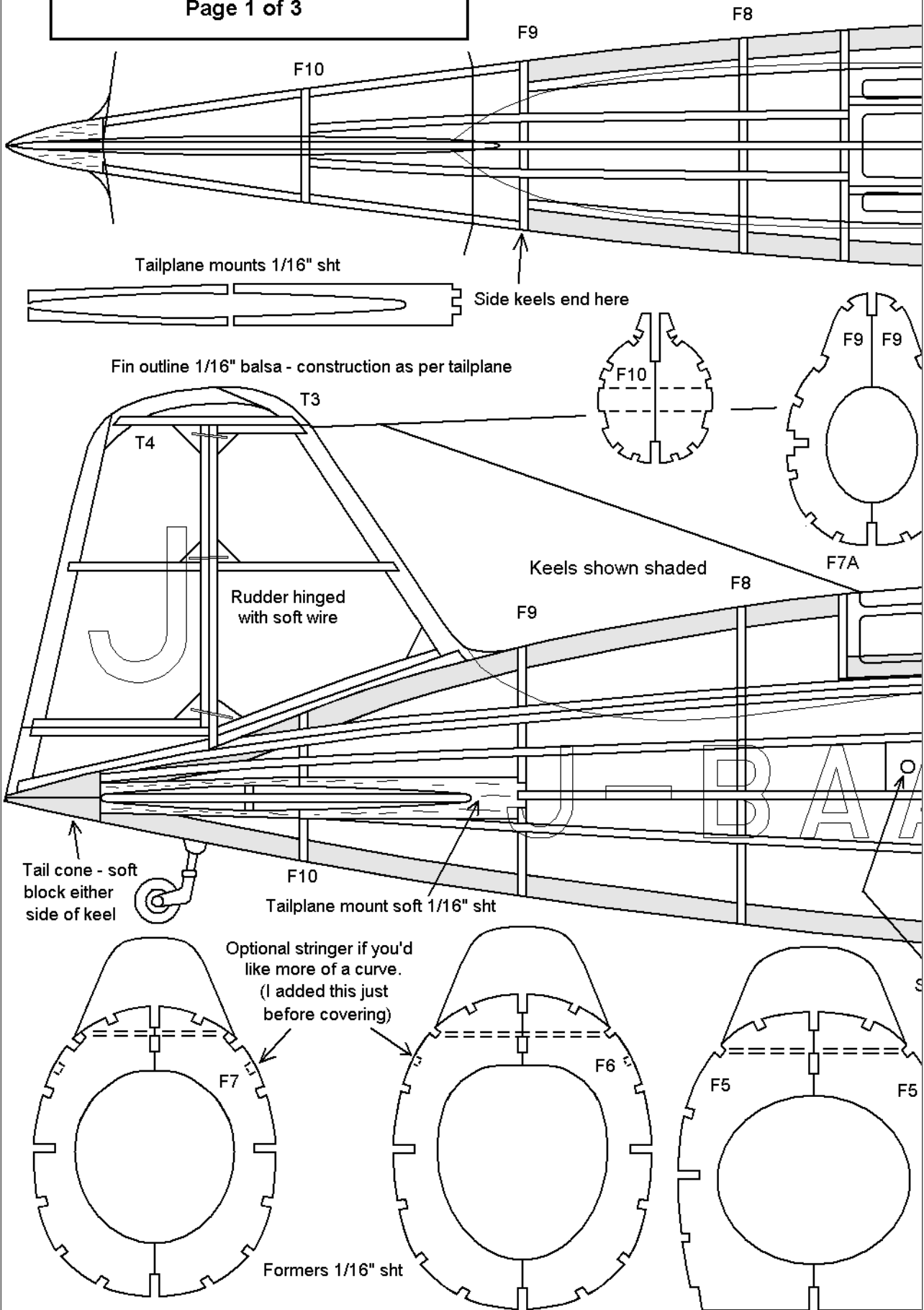

Mitsubishi Ki 15 Karigane I

1/20 scale free flight scale model

for electric or rubber power

Designed and drawn by Mike Stuart

Page 2 of 3

0 50 mm 100

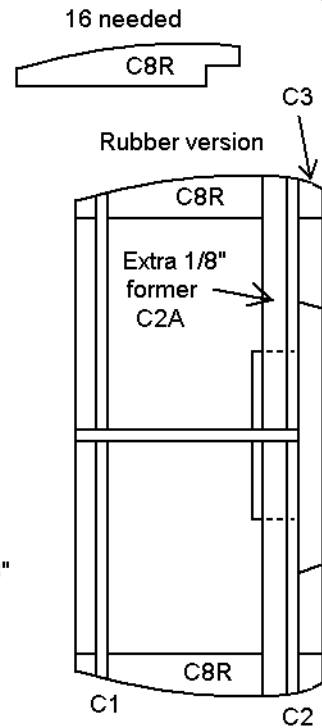
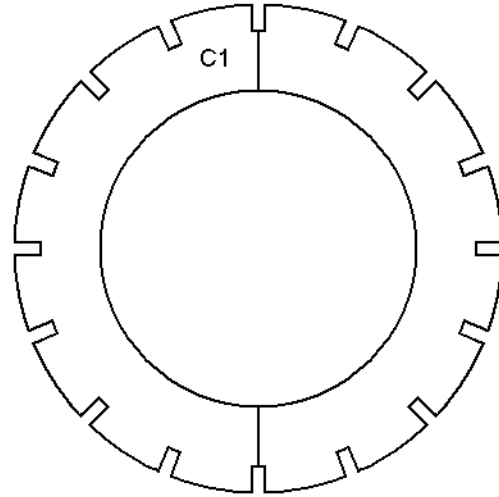
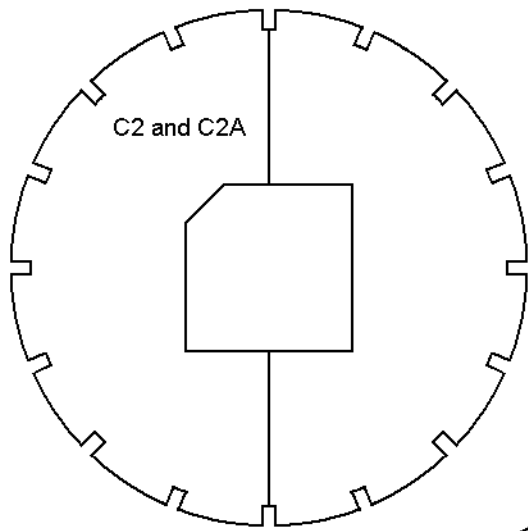

Fill in between parts C8 with soft 1/8" balsa, then carve and sand to shape

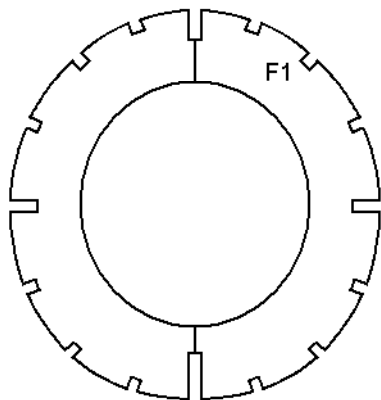
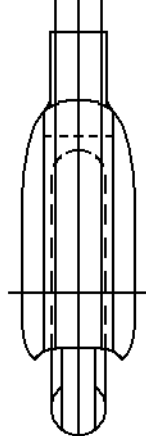
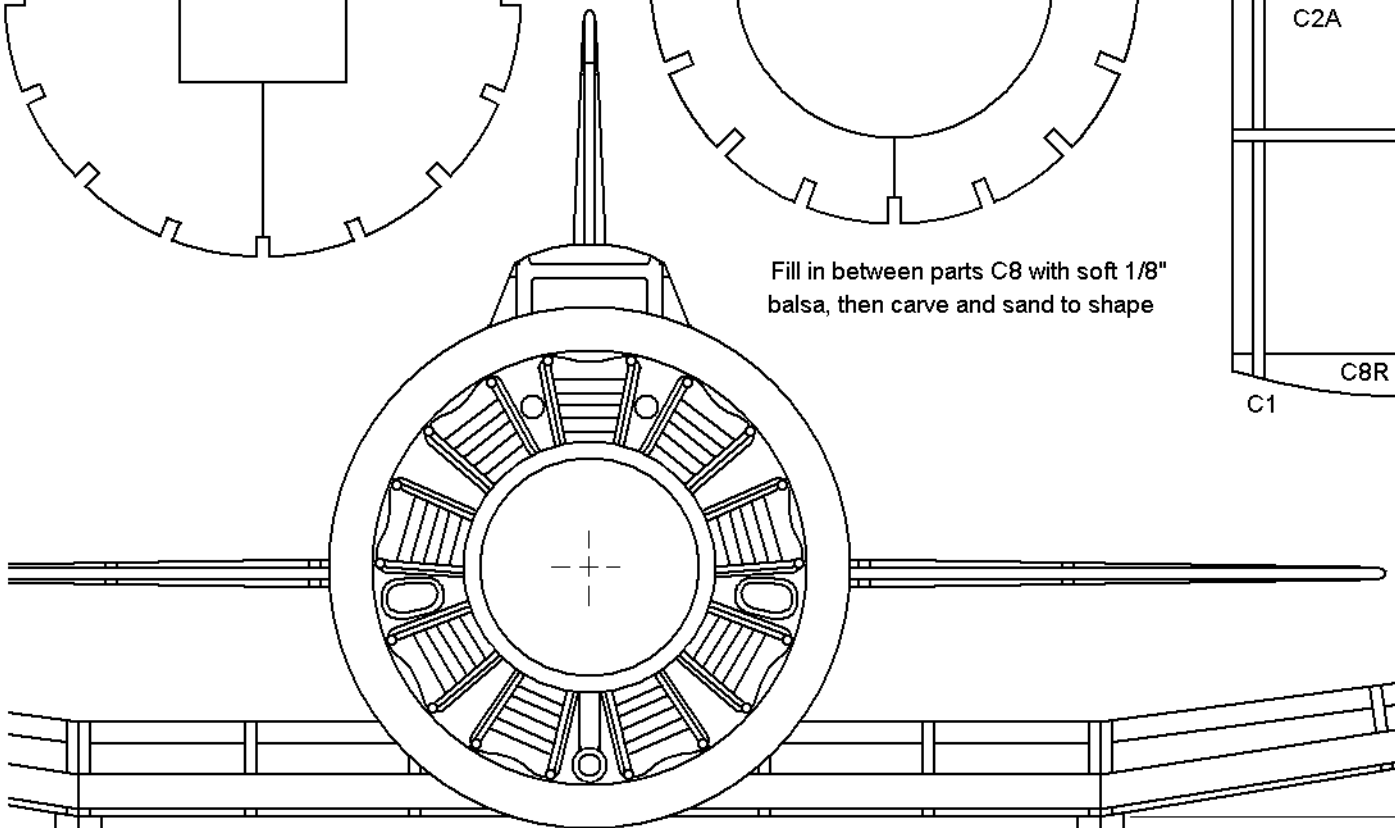

Wheel laminated from two 3/32" balsa discs and tyres from 1/16" sheet
Bush with aluminium tube

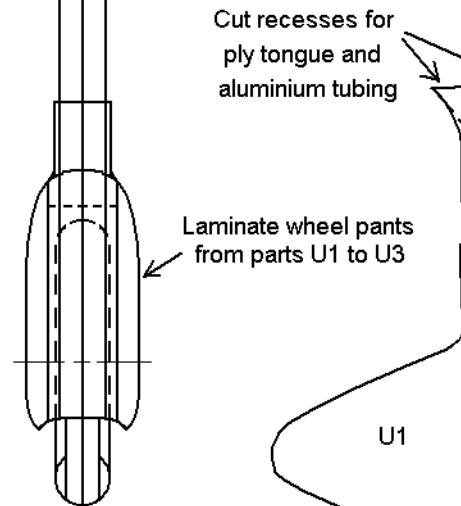
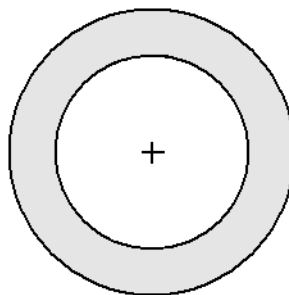

U1

150

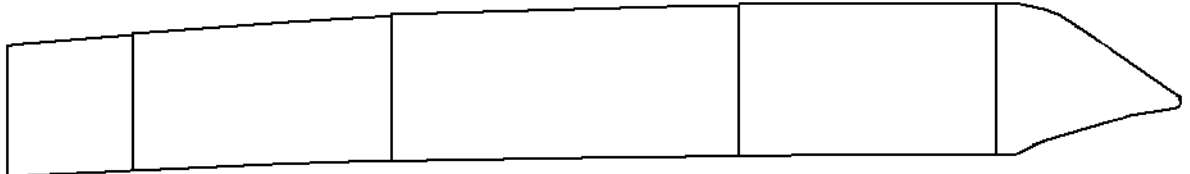
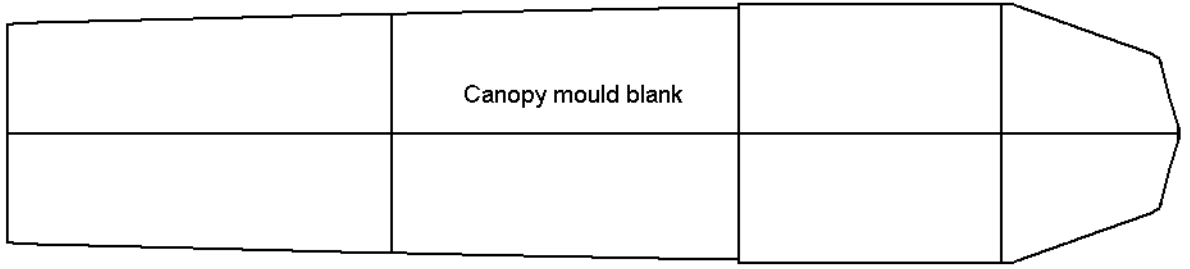
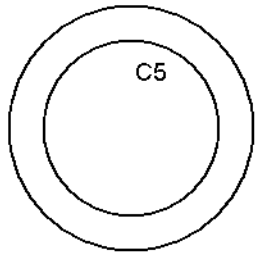

C3
C4
Solid nose plug laminated from 1/8" sht. (Leave the middles in C5, C6 and C7)

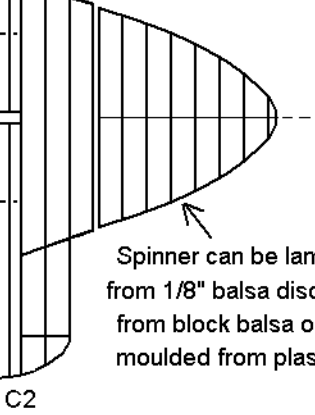

Spinner can be laminated from 1/8" balsa discs, turned from block balsa or plunge moulded from plastic sheet

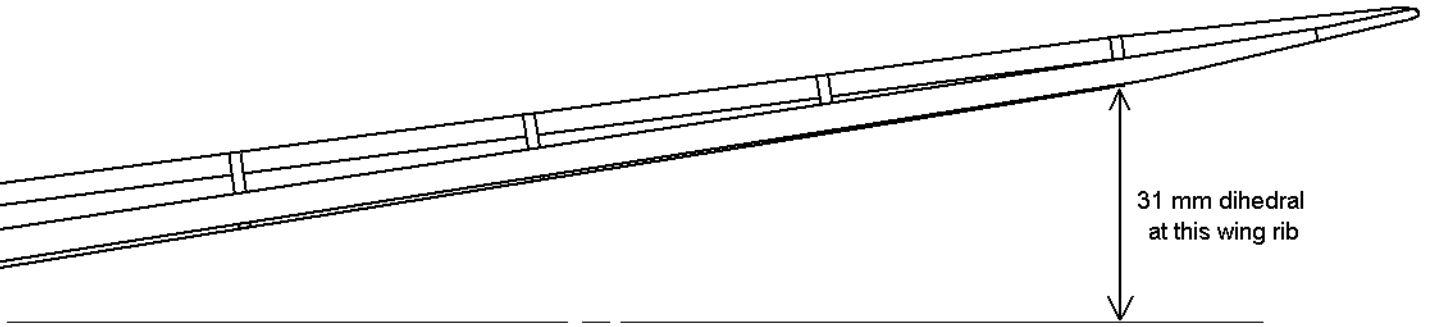
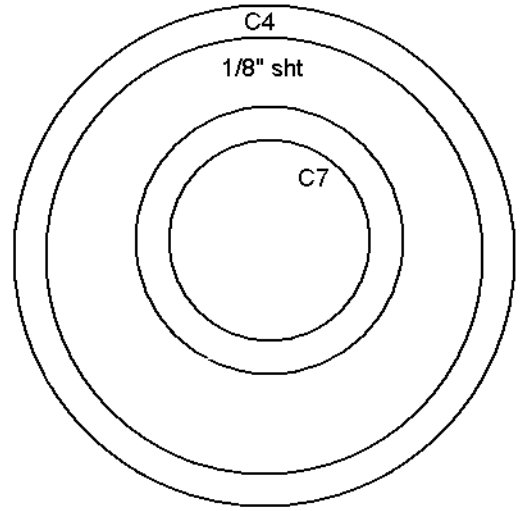
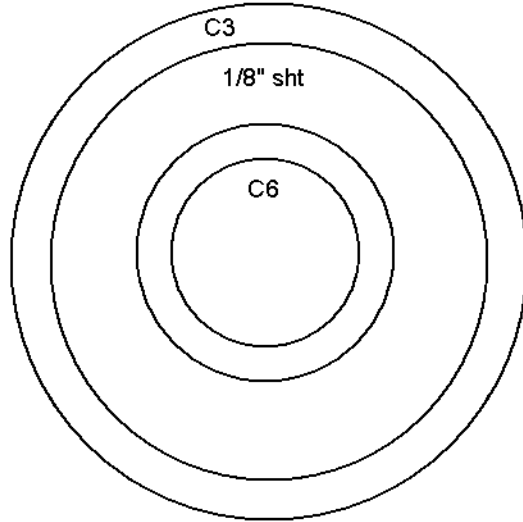

31 mm dihedral at this wing rib

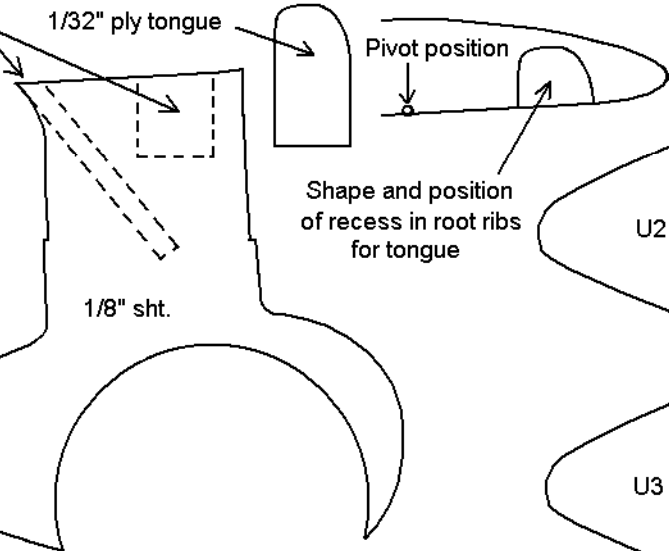

1/8" sht.

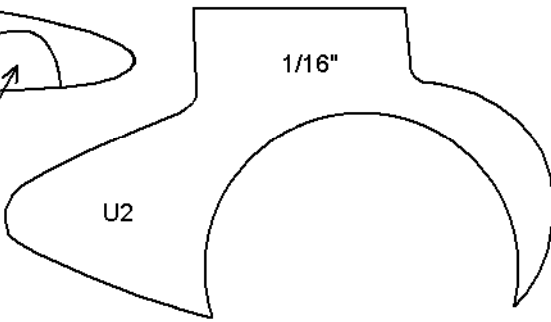

U2

1/16"

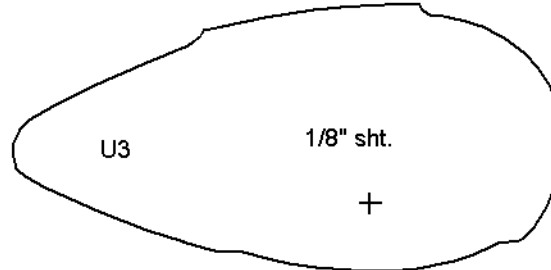

U3

1/8" sht.

+

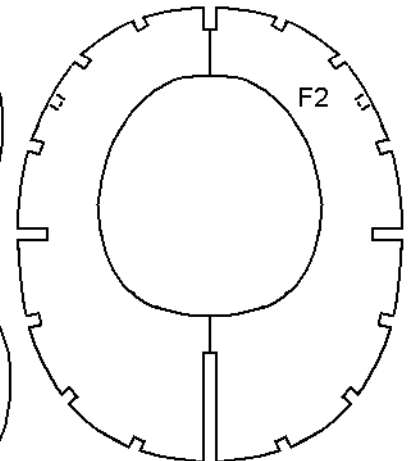

F2

0 50 mm 100 150

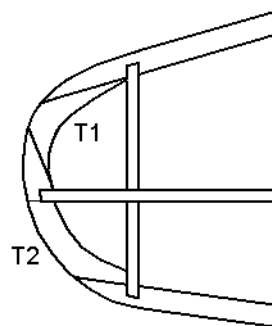
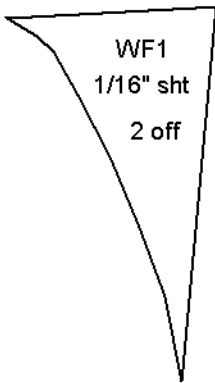
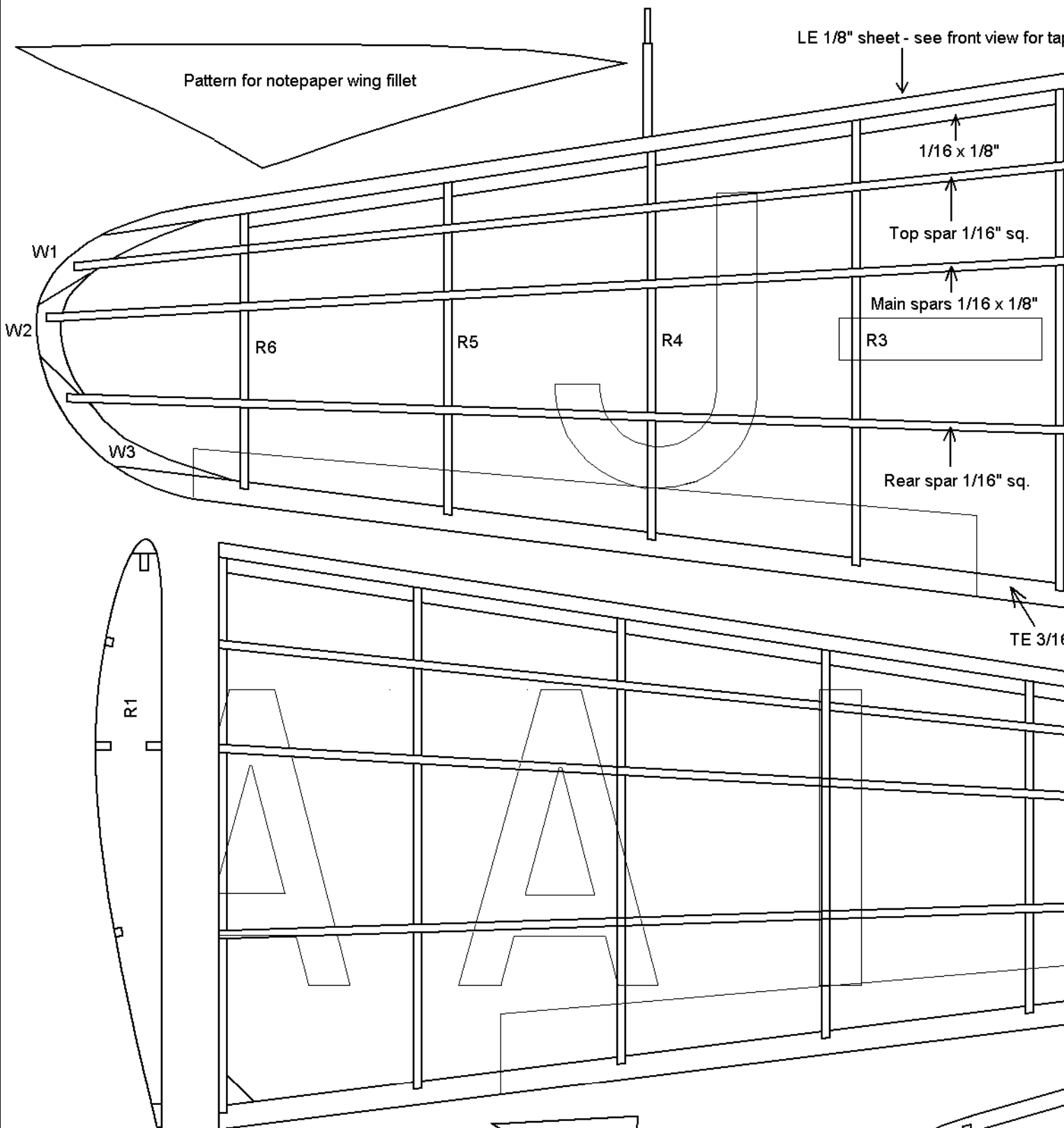

Mitsubishi Ki 15 Karigane I
1/20 scale free flight scale model
for electric or rubber power
 Designed and drawn by Mike Stuart
 page 3 of 3

Tailplane structure built flat on plan - outline 1/16" sheet
 Remove from plan and add 1/16" sq. to underside
 Finally sand in the taper and shape ribs to streamline

Torsion sprung U/C shown this side only

allow for taper

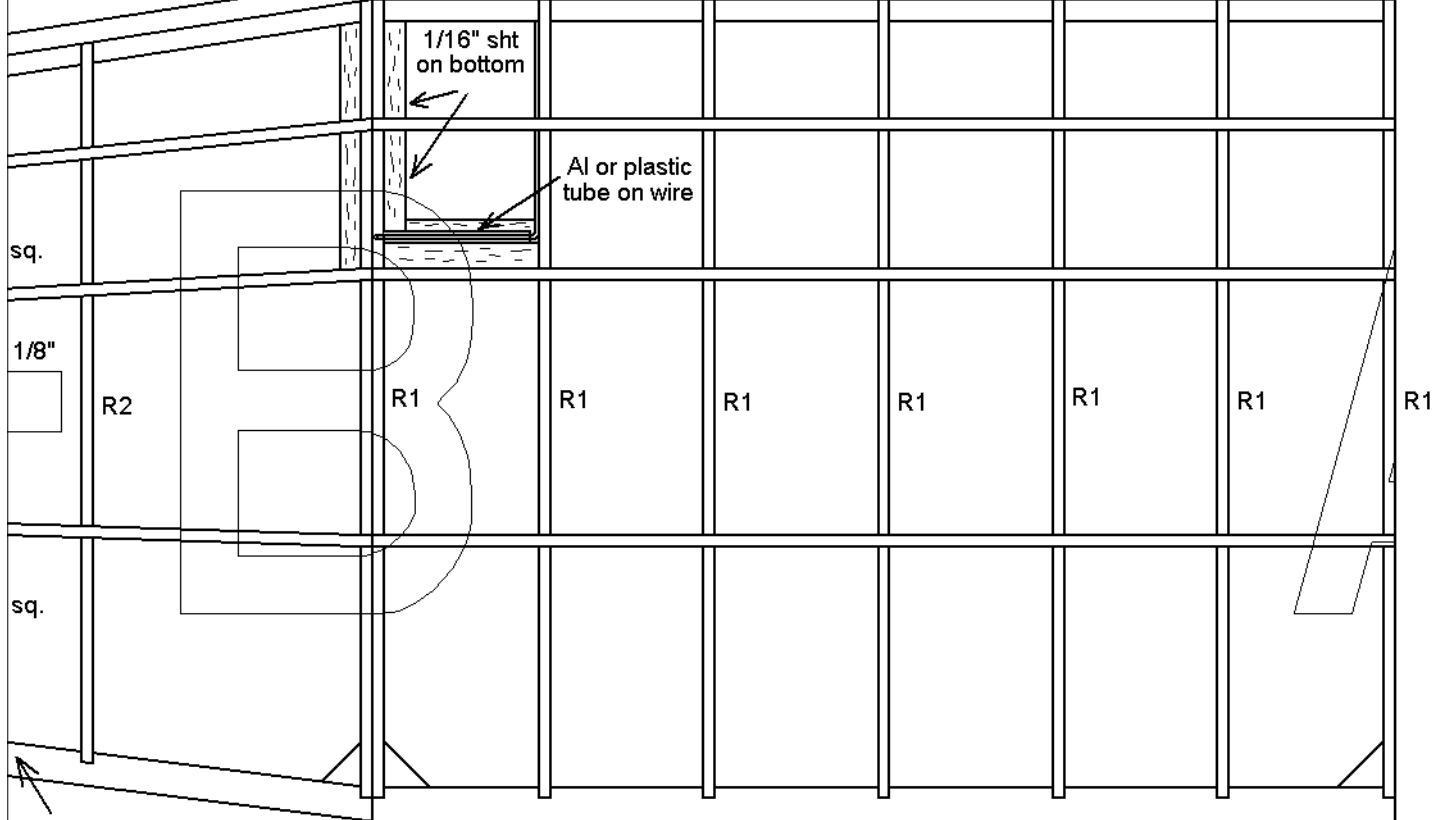

Dihedral break

Position of WF1

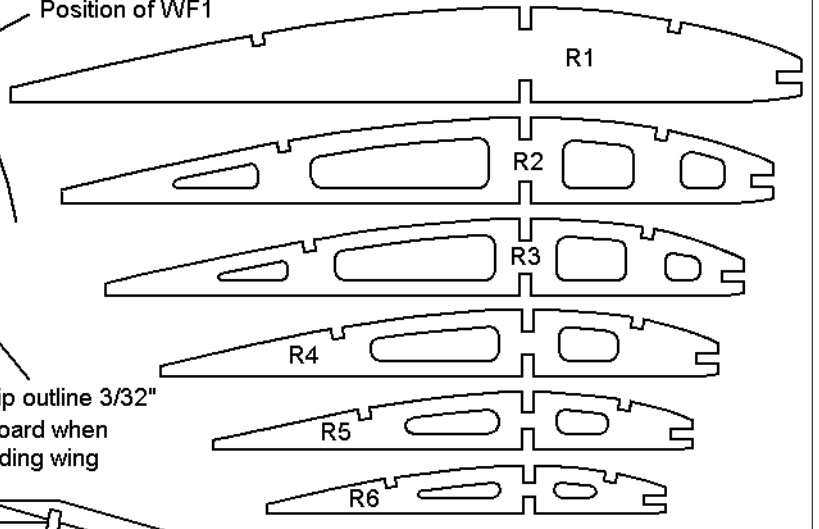
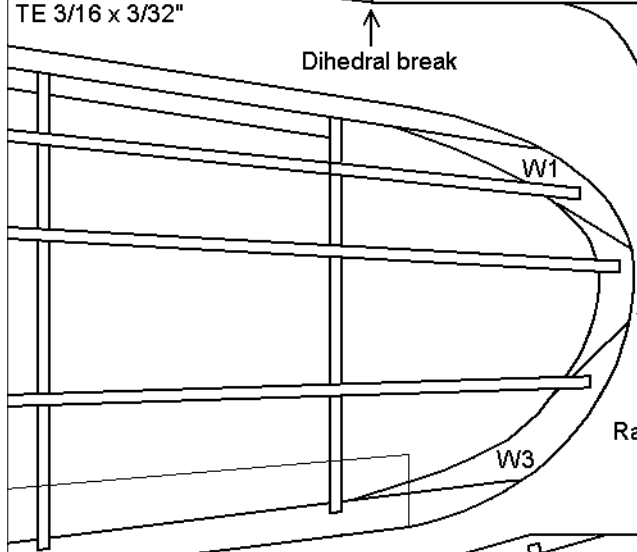

Raise tip outline 3/32" off board when building wing

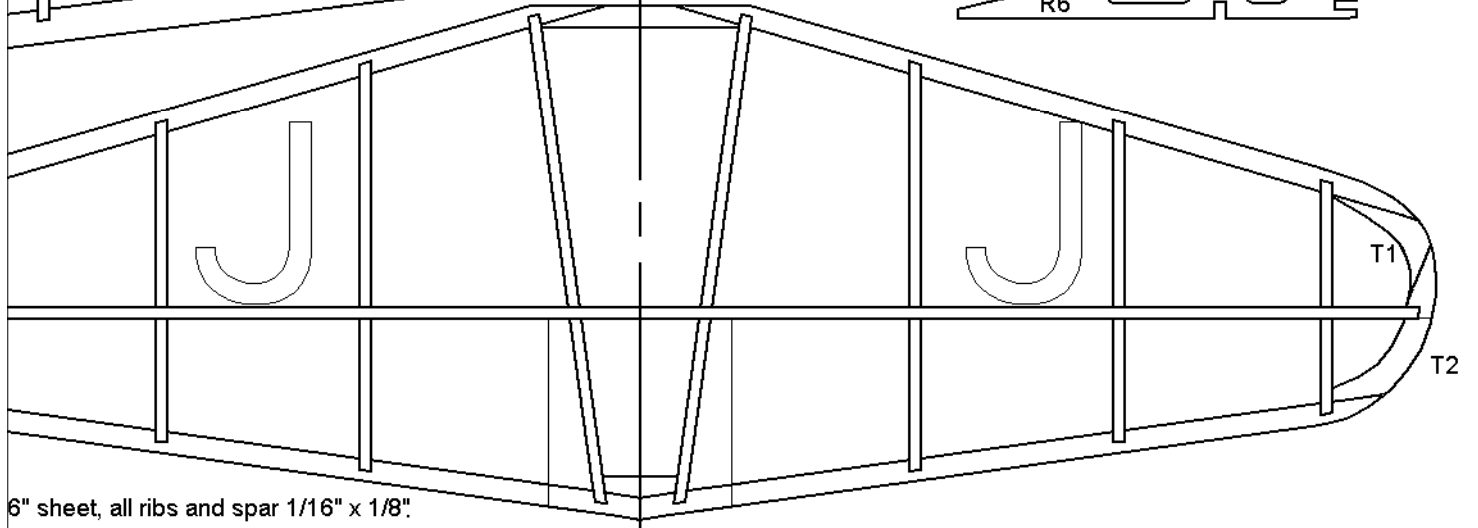

6" sheet, all ribs and spar 1/16" x 1/8".
 underside of all ribs and spar.
 streamline symmetrical section.