

Fuselage formers 1/16" balsa

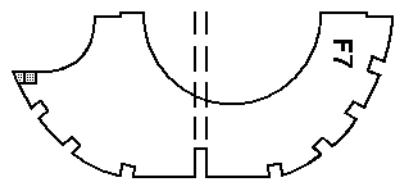

Spine carved from soft balsa block (hollowed)

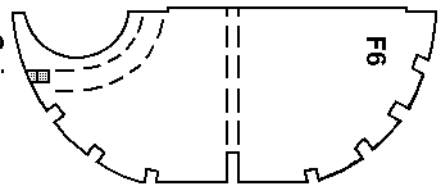
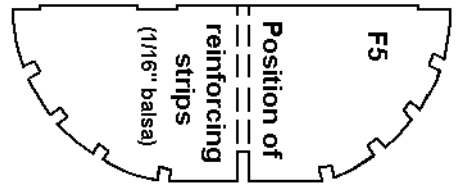
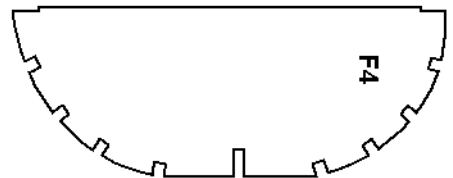
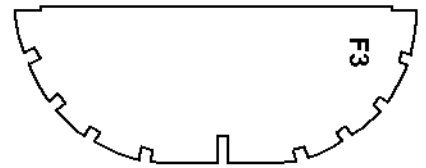
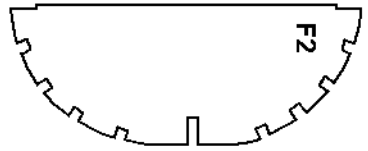
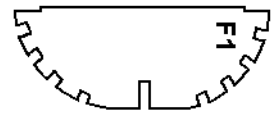

— join sheets here —

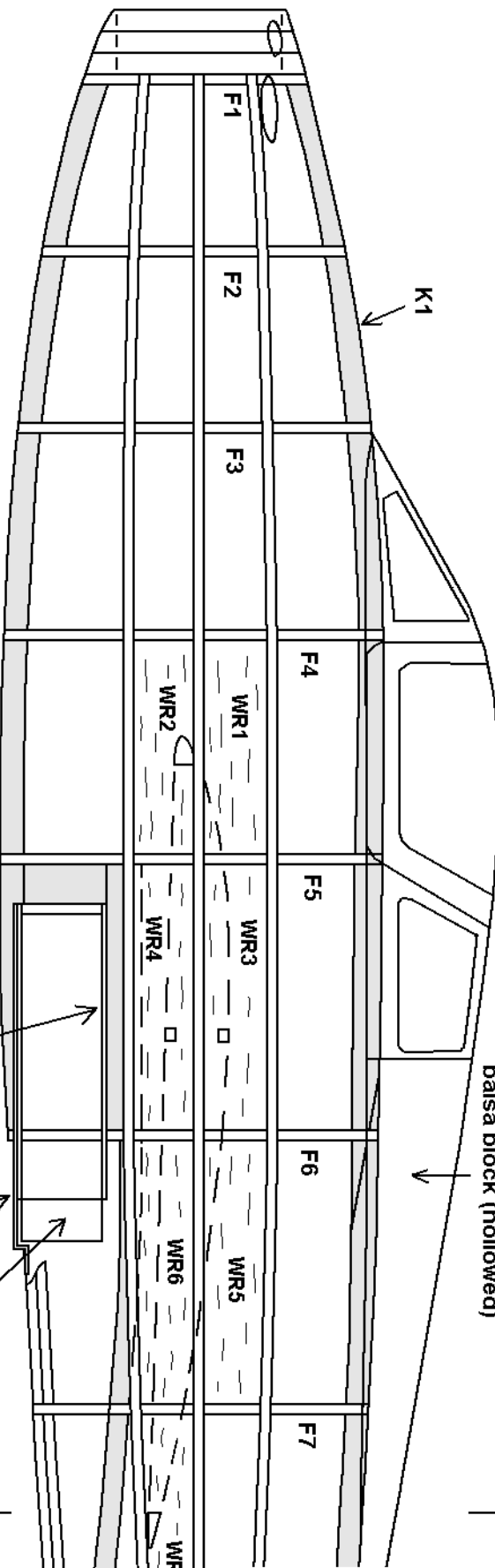

Republic F-84F Thunderstreak
 Free flight scale model for Rapier L2 power
 Designed and drawn by Mike Stuart
 Sheet 1 of 5

For clarity not all stringers shown

Motor mount from rolled notepaper
 Rapier L2 motor
 Wire retaining clip

— join —

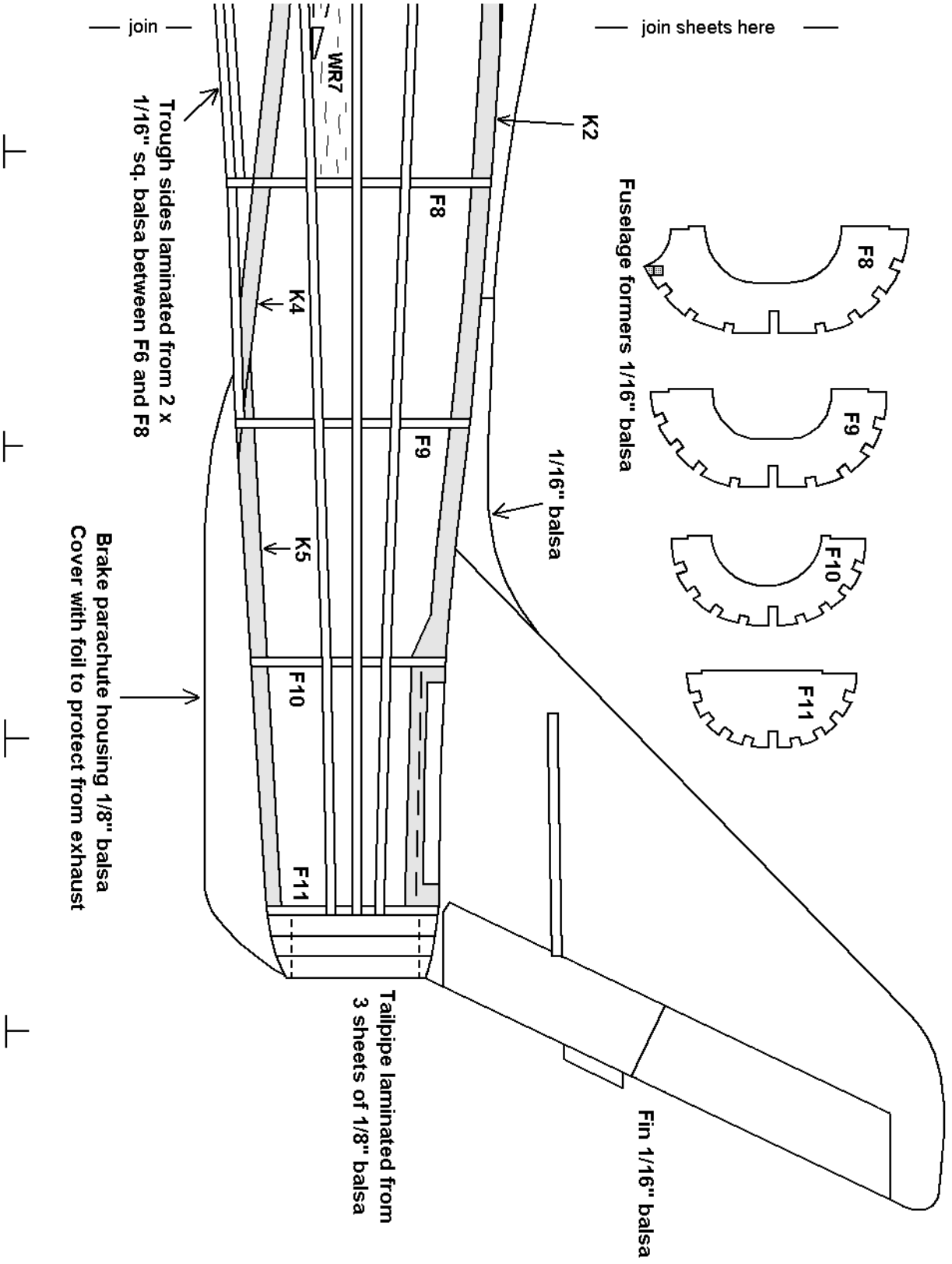

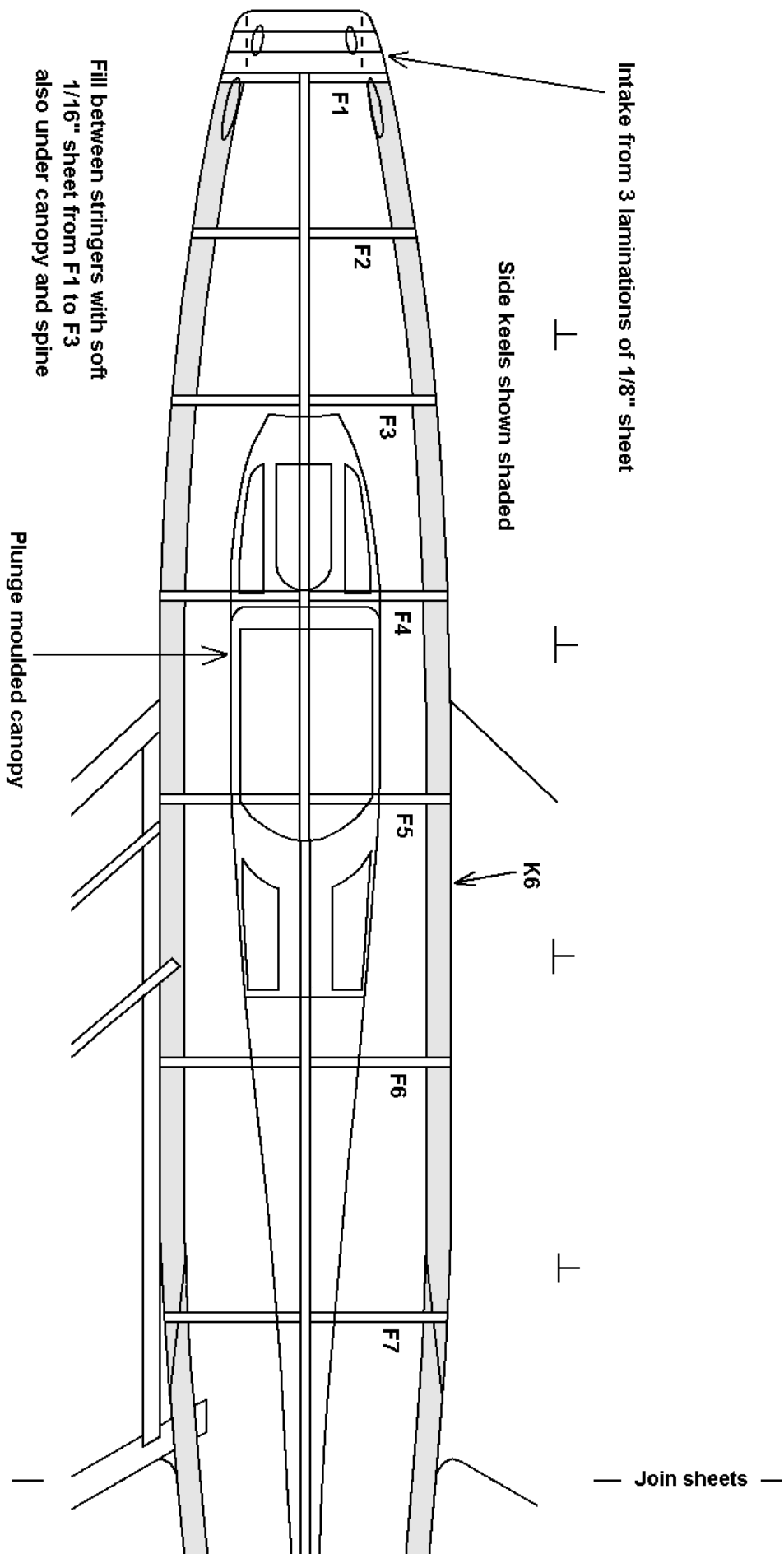

Fill between stringers with soft 1/16" sheet from F1 to F3 also under canopy and spine

Republic F-84F Thunderstreak
Sheet 2 of 5

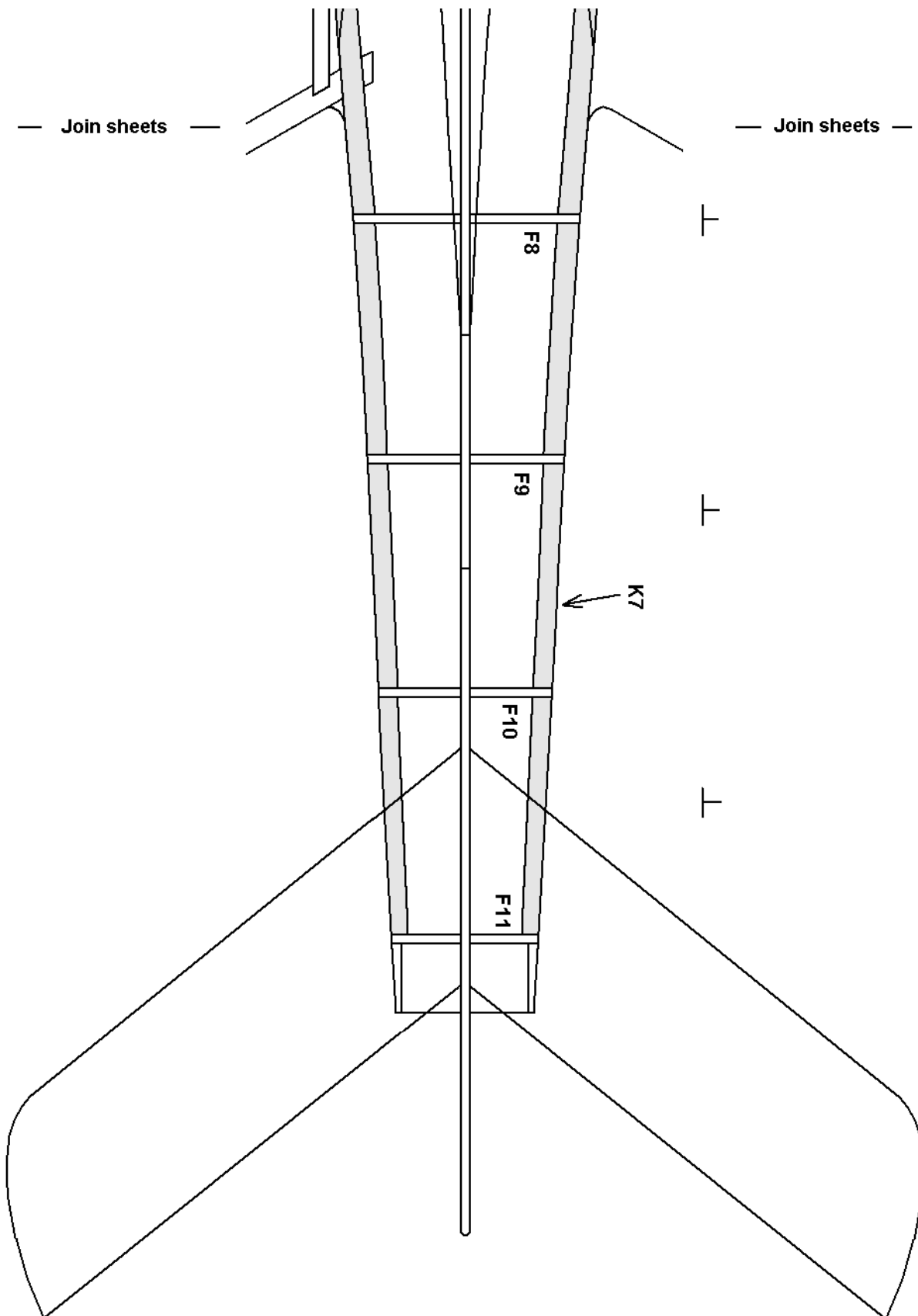

Republic F-84F Thunderstreak
Sheet 3 of 5

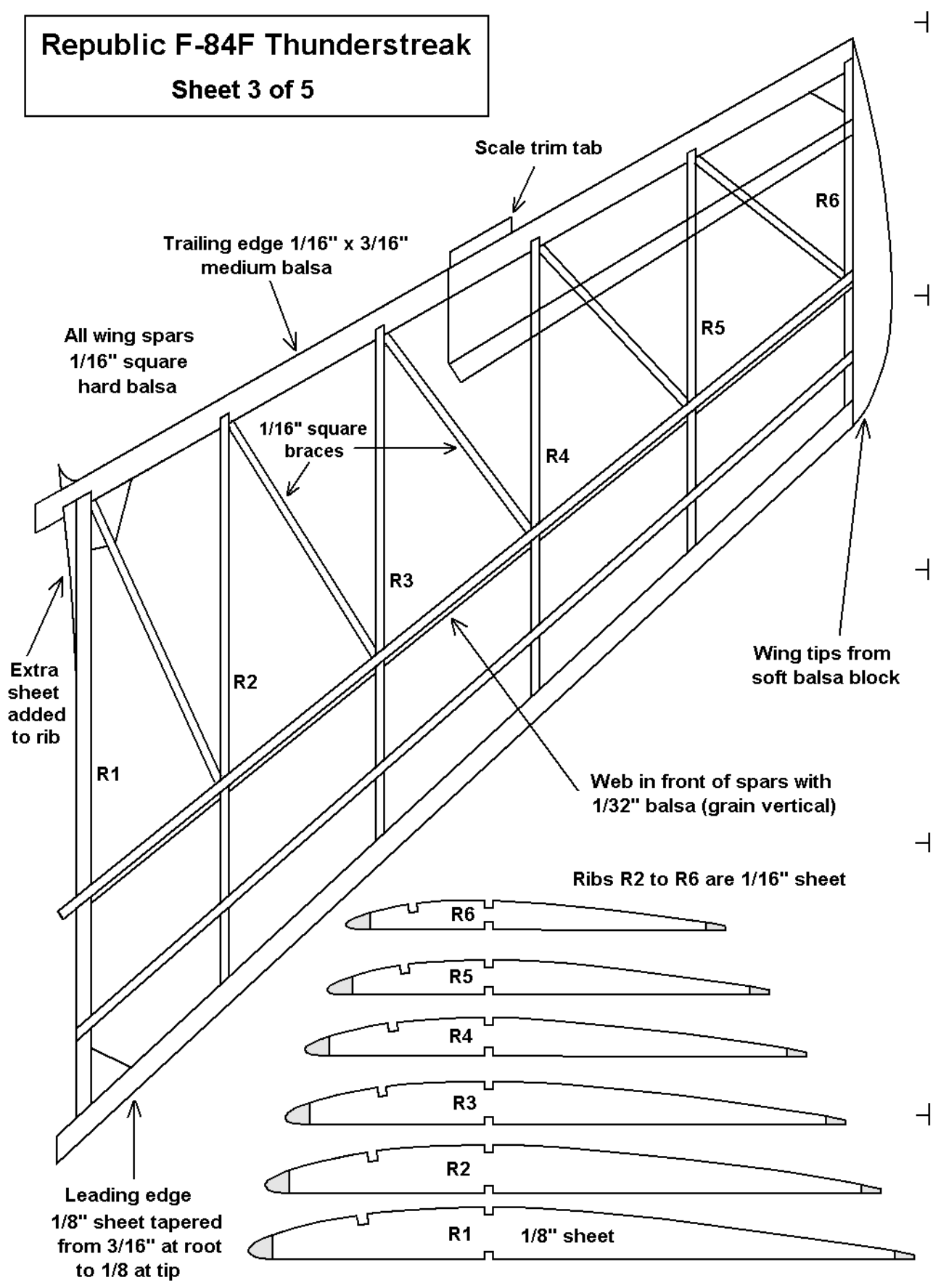

Republic F-84F Thunderstreak
Sheet 4 of 5

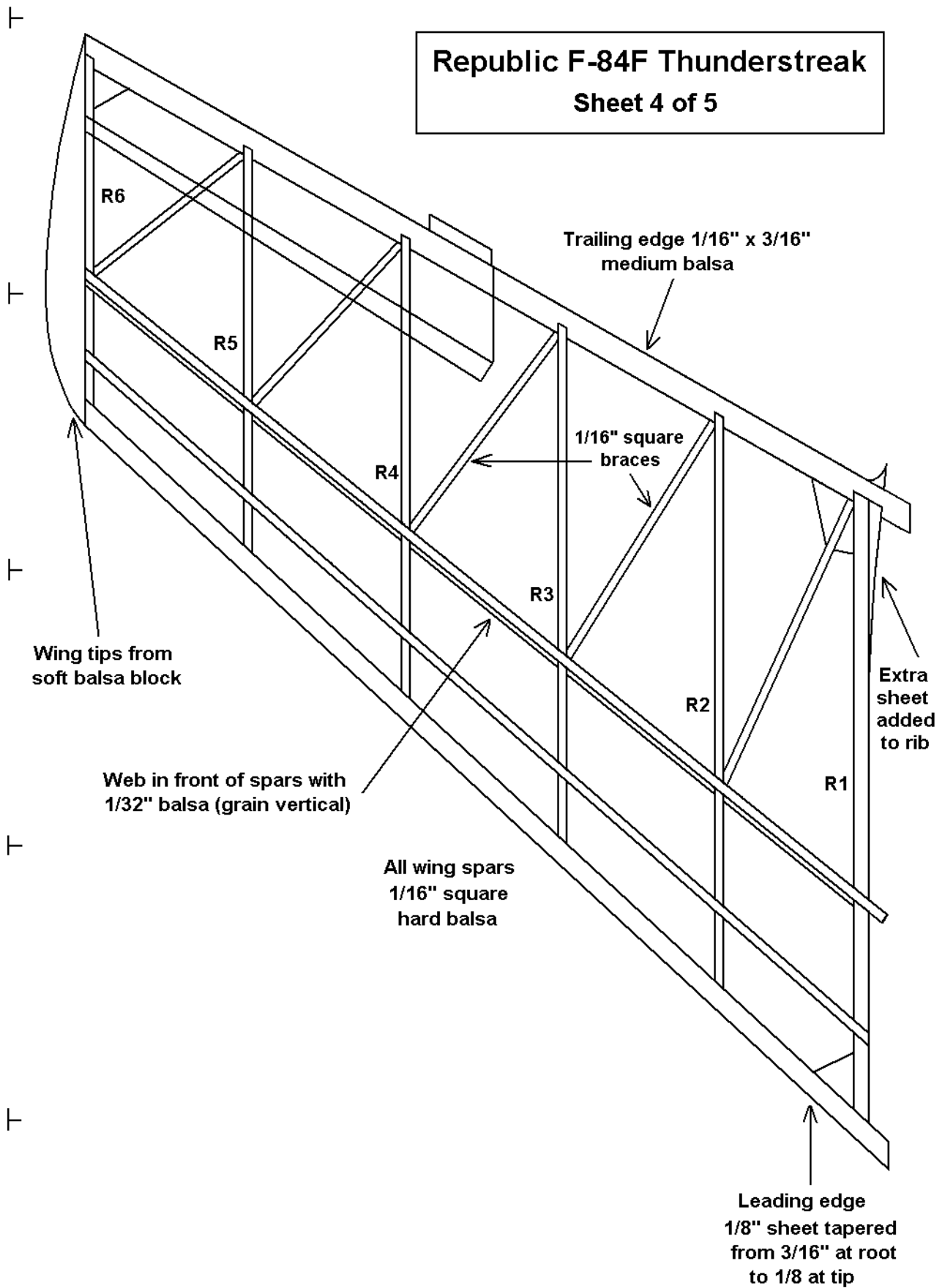

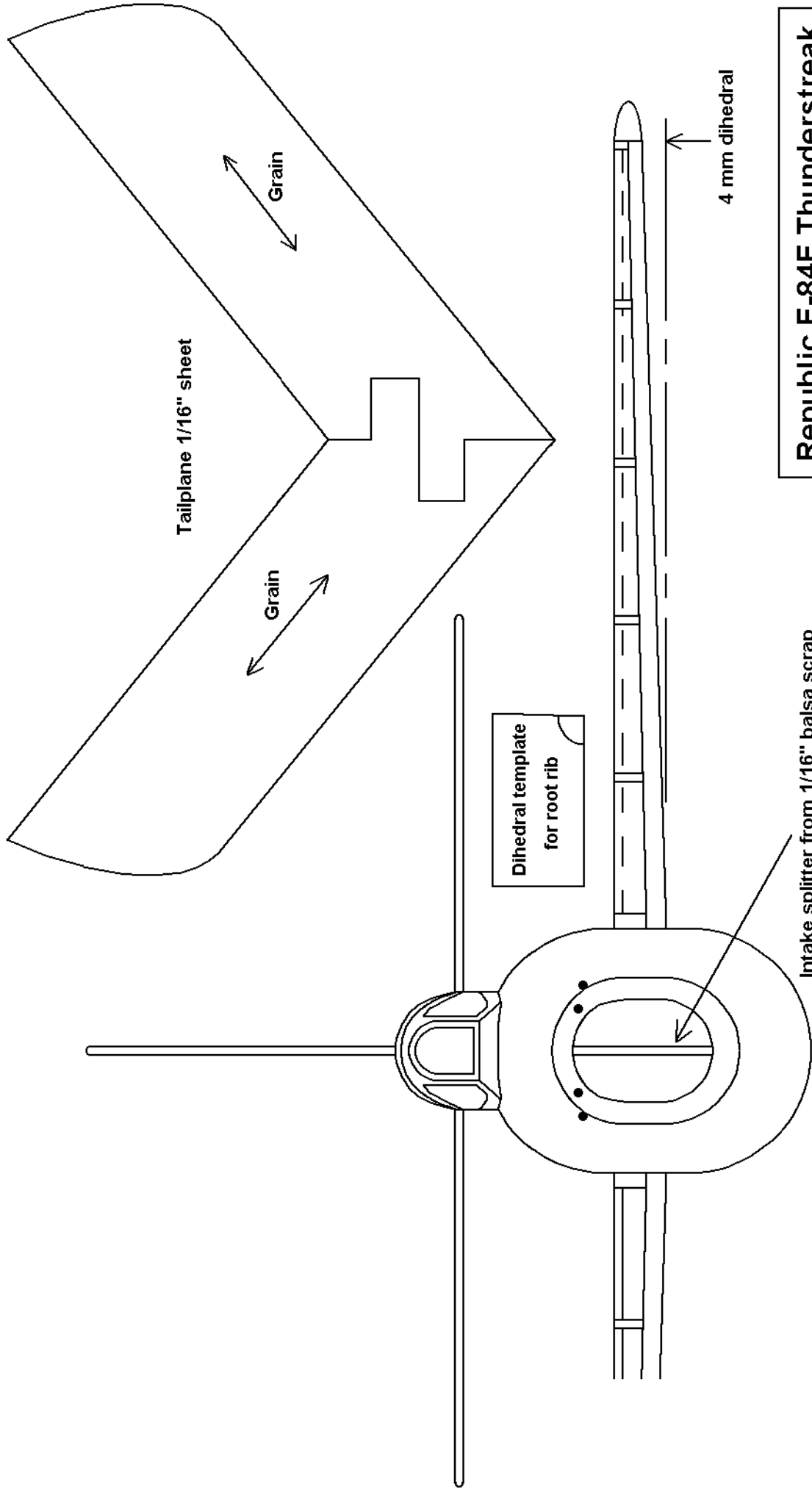

T T T T T T T

3"

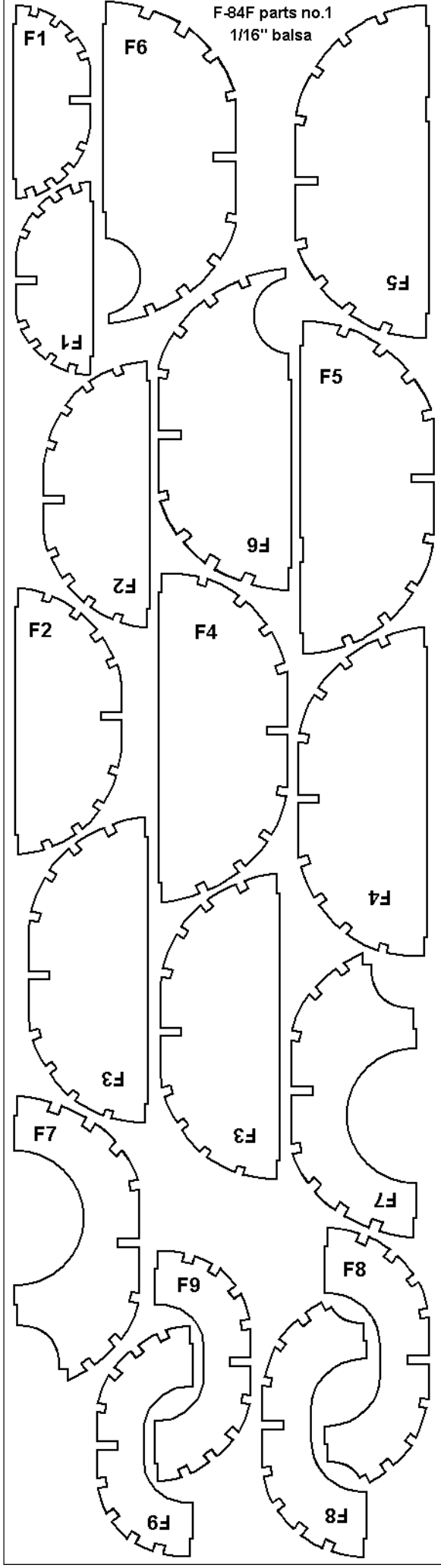

3"

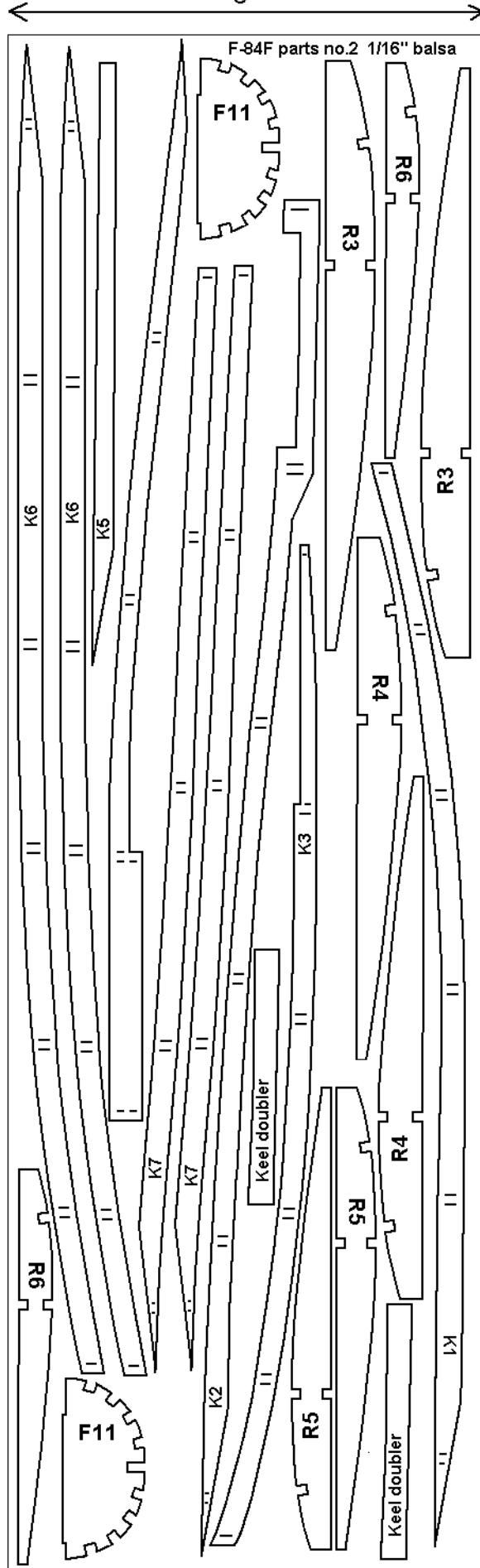

3"

